



VENUE HIRE CORPORATE

MAITLAND
REGIONAL
ART GALLERY



MRAG.ORG.AU

230 High St Maitland NSW 2320 | 02 4934 9859
artgallery@maitland.nsw.gov.au | mrag.org.au

VENUE HIRE CORPORATE



ABOUT

Maitland Regional Art Gallery is a dynamic venue for your special event. With impressive heritage and contemporary architecture, exhibitions that change seasonally and on site catering options, the Gallery is the ultimate unique location for a truly memorable event.

GALLERY SPACES

GROUND FLOOR

| | |
|--------------|-------|
| Approx. sqm: | 135m2 |
| Theatre: | 122* |
| Banquet: | 80* |
| Cocktail: | 260 * |

FIRST FLOOR

| | |
|--------------|-------|
| Approx. sqm: | 137m2 |
| Theatre: | 168* |
| Banquet: | 80* |
| Cocktail: | 230* |

*Capacity (guide only)

SERVICES & LOCATION

EAT & DRINK

Café Seraphine is MRAG's onsite café proprietor and offers a great range of dining and catering options. Café Seraphine can be contacted on 02 4934 7264 or seraphine.mrag@bigpond.com

Please note MRAG is not responsible for any aspect of catering services.

LOCATION

The Gallery is located in the Maitland CBD at 230 High Street. There is plenty of free public parking near the Gallery. Limited parking is also available onsite at the rear of the building. The gallery is also easily accessed via public transport.

Please note: due to the changing nature of exhibitions the capacity of Gallery spaces does vary as does the intimacy of each space. We strongly encourage you to meet with a member of the MRAG team onsite to ensure the desired space meets your expectations.

Please see floorplan overleaf.

AUDIOVISUAL

MRAG offers a range of audiovisual equipment which can be included within the gallery hire agreement.

GALLERY TOURS

Take advantage of the unique setting of your event by incorporating a closer look at the exhibitions on display with one of our art loving team members. Tour requests must be made at the time of booking to ensure availability.

ACCESS

You can access Maitland Regional Art Gallery via the High Street entrance or the Gallery car park off James Street. All public areas of the Gallery, including the shop and café, are accessible via ramps or lifts.

VENUE HIRE CORPORATE



FLOOR PLAN

GROUND FLOOR

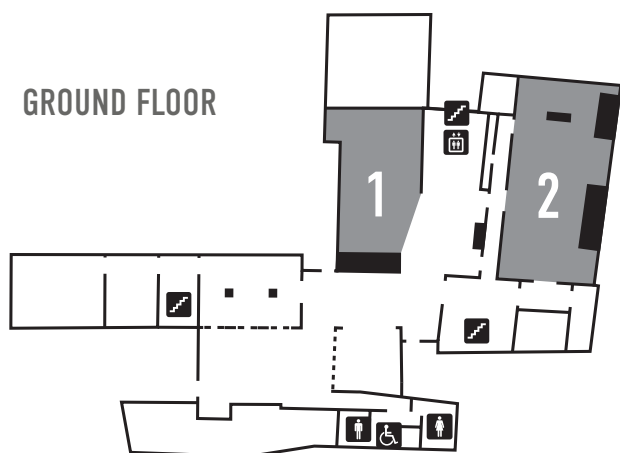

FIRST FLOOR

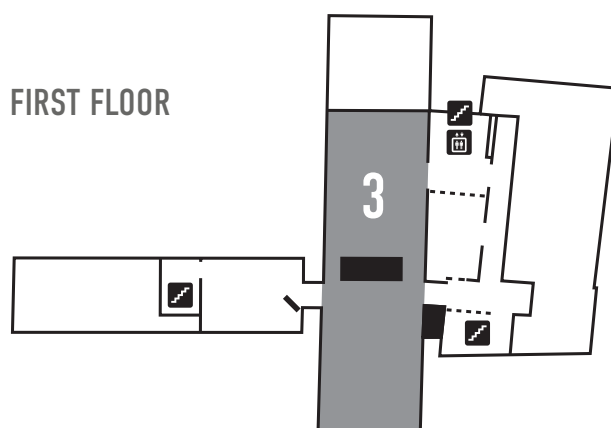

AFTER HOURS VENUE HIRE RATES

Category One Base hourly rate:

| | |
|-----------------|----------|
| Monday - Friday | \$215.00 |
| Saturday | \$270.00 |
| Sunday | \$320.00 |
| Security bond: | \$250.00 |

Garden Hire also available,
above rates applicable.

1. After hours Venue Hire must be for a minimum of three hours
2. Base hourly rate includes:
 - Two Gallery staff members for the duration of the event to facilitate set up/pack down and maintain Gallery security
 - General cleaning
 - Room lighting
 - Power
 - A selection of tables, chairs and linen
 - Audiovisual equipment: integrated sound system, wireless microphone, lectern. Excludes IT support.
3. All prices inclusive of GST
4. After hours rates include; Monday: 7am – midnight, Tuesday through Sunday: 7am – 10am & 5pm – midnight
5. *The Security Bond is a flat fee applied to all after hours venue hire bookings, refundable after post event inspections are carried out and meet the terms and conditions as stated in the venue hire contract
6. Should more than 150 persons be in attendance an additional Gallery staff member is required at an additional cost of \$82.50 per hour (inclusive of GST).